



£125,000

94 Chestnut Drive
Darlington
County Durham
DL1 4RS

EPC Rating C



LOUNGE 15' 8" x 15' 2" (4.78m x 4.64m) Double glazed window, radiator, electric fire with feature surround.

DOWN STAIRS W/C White suite comprising : low level wc, wash hand basin. Double glazed window and radiator.

KITCHEN/DINER 15' 2" x 8' 2" (4.64m x 2.51m) Range of wall and floor units incorporating : gas hob and gas oven. Stainless steel sink unit. Radiator and double glazed window . Double glazed french doors leading to the rear garden.

BEDROOM 1 13' 4" x 8' 9" (4.07m x 2.69m) Double glazed window and single radiator

BEDROOM 2 10' 7" x 8' 10" (3.25m x 2.70m) Double glazed window and single radiator

*****THREE BED FAMILY HOME***** Located in the Moorfield development, this modern and spacious home is close to local schools and ideal for a couple or family.

Property comprises - entrance vestibule, large living room, fully fitted kitchen with patio doors on to the garden, downstairs WC, to the first floor are two double bedrooms and one single, family bathroom with shower over the bath.

Large garden to the rear and a single garage.

BEDROOM 3 6' 11" x 6' 2" (2.13m x 1.89m) Double glazed window and single radiator

BATHROOM White suite comprising : Bath with shower over, wash hand basin and low level wc. Double glazed window and tiled surround.

GARDEN Patio and lawn garden, Fence surround.

Tenure: Freehold

Council Tax Band B

Local Authority: Darlington Borough Council

Agents Note: Whilst every care has been taken to prepare these sales particulars, they are for guidance purposes only. All measurements are approximate and for general guidance purposes only and whilst every care has been taken to ensure their accuracy, they should not be relied upon and potential buyers are advised to recheck the measurements

%epcGraph_c_1_355%

GROUND FLOOR
390 sq.ft. (36.3 sq.m.) approx.

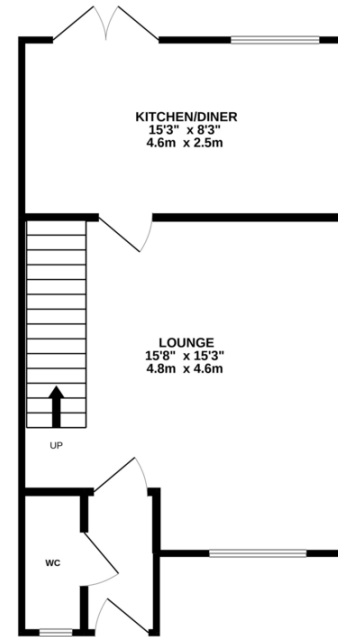

1ST FLOOR
367 sq.ft. (34.1 sq.m.) approx.

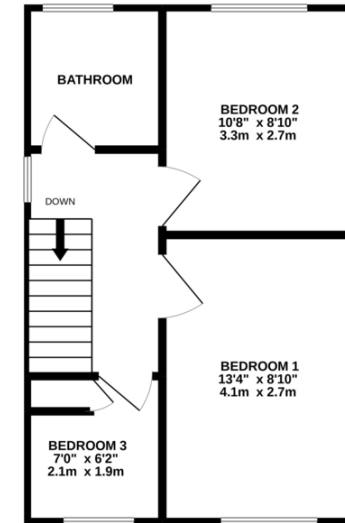

Sales Office

Alton House,
27-31 Grange Road
Darlington
County Durham
DL1 5NA

Contact Us

www.mypropertybox.co.uk
sales@mypropertybox.co.uk
01325 582101

Opening Hours

Mon-Fri: 9am - 5pm
Sat: 9am - 1pm